

**EQUFLOW****SS(0045, 0085, 00125) Stainless Steel Turbine Flow Sensor**

SS wetted parts, F.S. ranges of 2, 20, & 40 lpm, Frequency/Analog Output

**DESCRIPTION**

The SS housing flow sensor has low flow sensing capabilities in a wide range of applications, and is suitable for clear, opaque, neutral, corrosive and aggressive liquids including fuel.

An ultra light-weight turbine follows the fluctuation of flow very accurately and generates a high resolution IR reflected digital output signal.

In either flow controlled or monitoring applications, the stainless steel housed flow sensor can measure flow rates and totalize. Optional elements built into the circuit include a programmable K factor, flow switch and a programmable batch feedback function for pump control.

External optional electronic packages include model 6100 digital to analog (4-20 mA) converter. Also model S601, a professional, solid batch and flow controller that can be used as a monitor and/or totalizer and model 6300 switch module for use with

**Features**

- Turbine flowsensor with high resolution output
- Flow measuring by revolutionary IR turbine reflection
- 316 Stainless Steel & PFA parts for high chemical and corrosion resistance
- High accuracy and repeatability
- Suitable for opaque liquids
- Outstanding performance for high process pressure

**SPECIFICATIONS**

<b>GENERAL</b>	<b>Patent No. US5388466</b>		
<b>Model</b>	<b>SS0045</b>	<b>SS0085</b>	<b>SS0125</b>
Inner diameter in mm	4.5	8.5	12.5
Flow range	0.06 - 2 L/min	0.5 - 20 L/min	1.5 - 40 L/min
Accuracy	1% of reading	1% of reading	1% of reading
Repeatability	< 0.15 %	< 0.15 %	< 0.15 %
Wetted parts	316 SS/PFA /Ruby	316 SS/PFA /Ruby	316 SS/PFA /Ruby
O-ring Seals	Viton or EPDM	Viton or EPDM	Viton or EPDM
Tube connection thread/hosebarb	1/4 " NPT/BSP	3/8 "NPT/BSP	1/2 " NPT/BSP
Liquid temperature in °C	-20 to +80	-20 to +80	-20 to +80
Max. pressure at 20° C in bar (psi)	200 (2900)	200 (2900)	150 (2180)
Viscosity in cSt.	0.8 - 10	0.8 - 10	0.8 - 10
K factor (water) in pulse/Litre	110,000	6,100	2,000
Power supply	5 - 24 Vdc	5 - 24 Vdc	5 - 24 Vdc
Output signal	5 - 24 V sq. wave	5 - 24 V sq. wave	5 - 24 V sq. wave
Power consumption	34 mA at 5 V	34 mA at 5 V	34 mA at 5 V
Electrical lead	PVC 1 meter	PVC 1 meter	PVC 1 meter
Dimensions incl. housing (mm)	L-72.6, ø 40	L-72.3, ø 40	L-73.6, ø 40
Recommended Line filter	100 µm	100 µm	150 µm

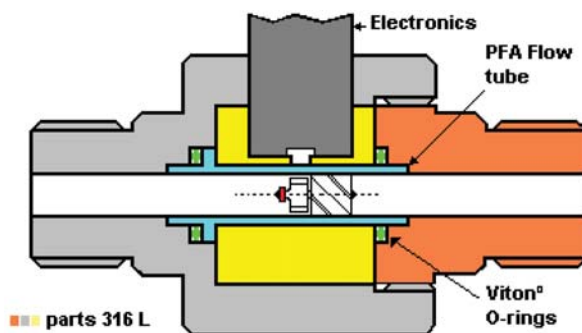

**Working Principal:**

A static worm forces the passing fluid to spin. The spinning fluid drives a rotor with reflectors into a frictionless rotation. A high resolution infrared sensor determines the rate of flow by counting the passing reflections. The set up even allows the flow of opaque liquids to be determined accurately. The ultra low mass of the rotor guarantees a quick response to changes in the rate of flow

**Wiring:**

**Power Supply 5-30 Vdc or 5 Vdc (low voltage option)**

**Output All Sensors: NPN square wave**

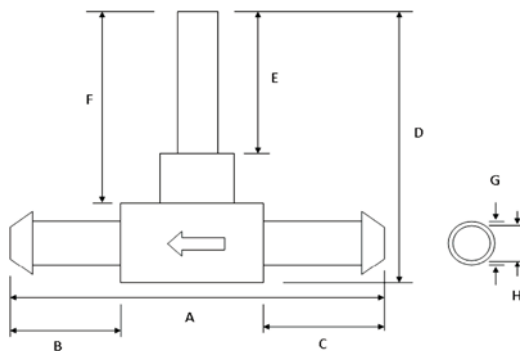
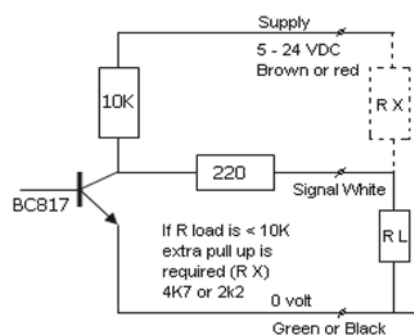

Dim. (MM)	0045- NPT	0045-BSP	0085- NPT	0085- BSP	0125- NPT	0125- BSP
A	72.5	67	72.3	67.2	73.8	71.2
B	14.7	14.4	14.8	12.35	15.5	14.2
C	14.7	14.4	14.8	12.35	15.5	14.2
D	68.5	68.5	71.2	71.2	76	76
E	28.5	28.5	30.3	30.3	30	30
F	12	12	12	12	12	12
G	13.8	13.8	17.2	17.2	21.7	21.7
H	4.5	4.5	8.85	8.85	14	14
I	40	40	40	40	45	45

**ORDERING INFORMATION**

**ABCDEFGH  
SS0045TNP01XX**

A Model	B Tube Dia./Range	C Wetted Material	D Connection	E Cable Type	F Cable Length	G Power	H Options
SS	0045= 4.5 mm/0.1-2 l/min 0085= 8.5 mm/1.0-20 l/min 0125= 12.5 mm/2.0-38 l/min	S=316 SS/PFA /Ruby	N= NPT B= BSP	P= PVC	01= Standard 02= 2 meters	XL= 5 VDC XA= 5-30 VDC XX= 5-30 VDC w/microchip	Built-in to Housing Electronics  <sup>1</sup> PD= Pulse Divider <sup>1,2</sup> F= Flow Switch <sup>1,2</sup> B= Batch Function <sup>1</sup> Requires X power option <sup>2</sup> Requires model 6300 switch h

**Ask About Our Other Eqflow Products.....**

- Standard Flow Sensor
- Disposable Flow Sensor
- Electronic packages for use with Flow Meters
  - 6100 digital to analog (4-20 mA) converter
  - S601 solid batch and flow controller
  - 6300 switching module for flow switch and batch option

