

GOTEC

EDS 035 Miniature Diaphragm Pump

Solenoid Operated, Flow to 117 ml/min, Pressure to 0.3 Bar (4.35 PSI)

DESCRIPTION

Model EDS 035 pump is ideally suited for transfer of compatible liquid media at low pressures and flow rates.

The pump operation is straight forward with a solenoid moving a diaphragm within a plastic housing that has opposing duckbill check valves mounted in the pump inlet and outlet. The diaphragm and check valve material is EPDM. Inlet and outlet connections are barbed hose type and the pump housing rotates to best orient the barbs to the most suitable mounting position.

The pump is useful for many fluid transfer applications in equipment for HVAC, Medical, Automated Chemistry, and General Automation Applications.

SPECIFICATIONS

GENERAL

Maximum Pressure- 0.3 Bar (4.35 PSI)
 Maximum Flow Rate- 117 ml/min (1.54 GPH)
 Maximum Suction- 4.9 feet
 Viscosity Range- 1...600 mm²/s
 Filter- 100 Mesh
 Supply Voltage- 12, 24, 110, 230VAC, diode rectified
 Frequency- 50/60 Hz
 DC Operation: Optional model PD-106 DC driver board
 Power Consumption- 18 W
 Operating Factor- 100% continuous duty@20°C
 Ambient/Process Temperature Range- 1 to 50°C (33.8 to 122°F)
 Dimensions- See Dimension Drawing



FEATURES

- o Inert Wetted Parts
- o Simple Opposing Check Valve Operation
- o Small Size
- o Easy Mounting
- o Rated for Continuous Duty
- o Low Power Consumption

Pump Housing Material- PVDF (wetted) and PEEK (non-wetted)

Electrical Connections- Male DIN Spade (3 x 6.3 mm .08 mm), ISO/DIN 43650 form B, or 130 mm flying leads

Insulation: Class F-100% ED / 20 [°C] with heat sink (Class H on request), Class I

Piping Connections- 1/4 " O.D. Barb

Optional Mounting- Integral Heat Sink w/2ea 1/8" Holes 3/4" on center (see drawing)

Weight- 90 g

FLOW CURVE

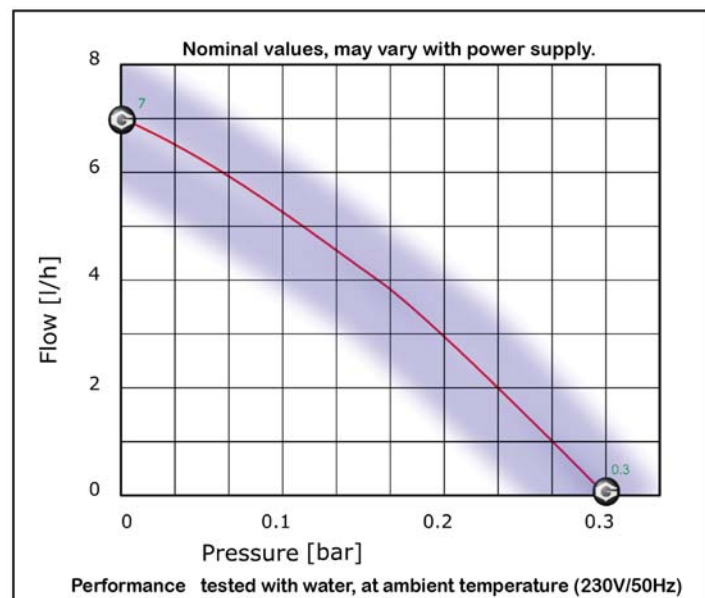

ELECTRICAL

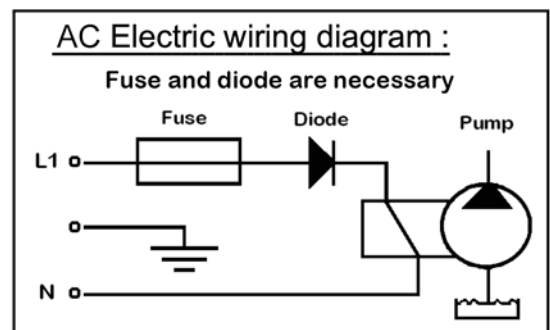

EFFECT OF COIL TEMPERATURE RISE ON FLOW RATE

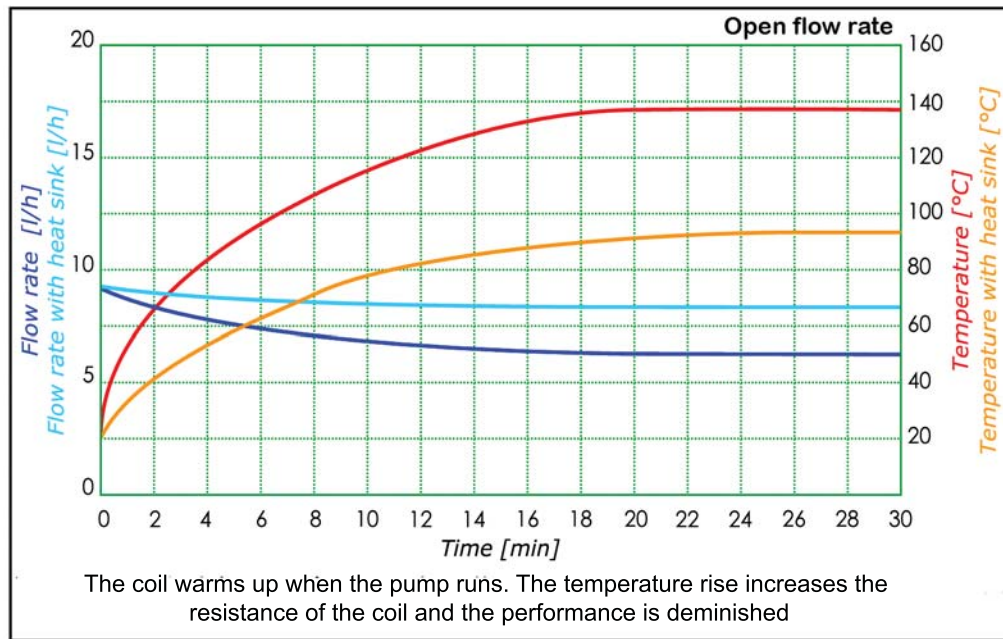

DIMENSIONS (MM)

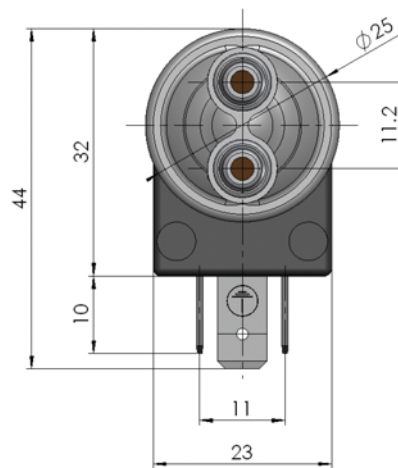
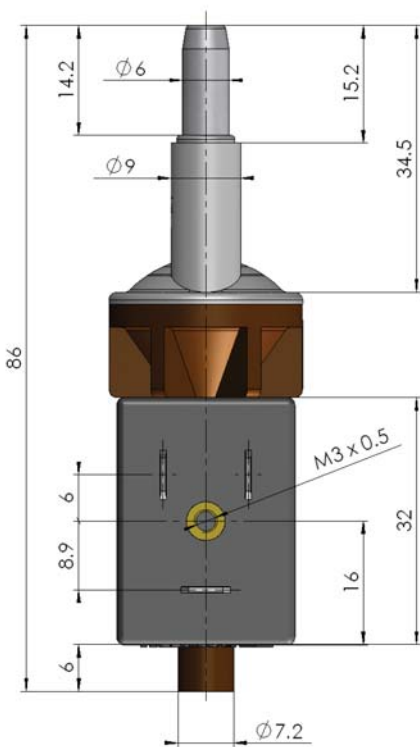

HEAT SINK

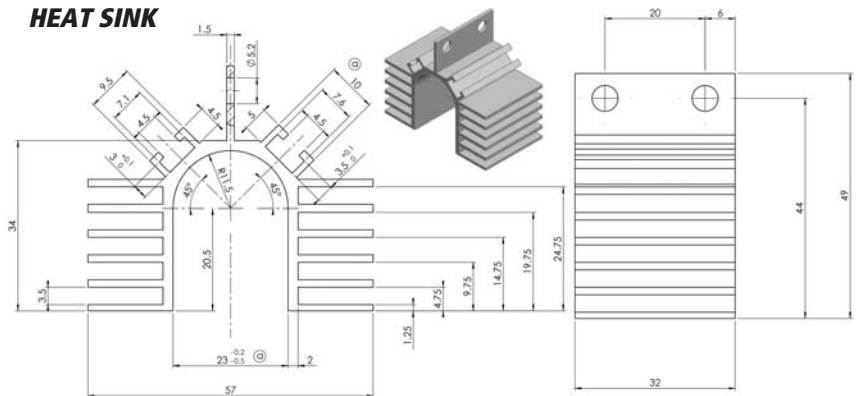

ORDERING INFORMATION

ORDER NUMBER

EDS-035-24V: Pump With 24V Solenoid

EDS-035-110V: Pump With 110V Solenoid

Options:

Model 106628- Heat Sink

Model 1N5406- Diode

Model PD-106- DC driver board, 9-35 VDC in, 9-35V pulsed DC out