

CLARK

Pressure/Vacuum Pump Model Series 15000

12VDC Powered Rotary Vane Pumps. Gas Flow to 12 LPM



DESCRIPTION

These rotary vane pumps are an excellent pressure/vacuum source for gas analyzers, medical devices, process samplers and other analytical instrument applications. They are also useful for material handling and many general automation applications.

The pumps are quiet, reliable and mount in any position. The units operate oil free. The pump vanes have a service life of 1,000 hours and are easily field replaced without special tools.

SPECIFICATIONS

Max Pressure/Max Vacuum- 1500 mbar/800 mbar

Maximum Flow- 12 LPM

Vane Material- Carbon

Media- Inert gases

NOTE

Operation at a somewhat lower than pump design voltage will yield a significantly longer life of the motor and the pump while also decreasing the current draw and operating noise of the unit.

If used for continuous operation, we recommend selection of a pump that has a slightly higher pumping capacity than needed during normal operation.

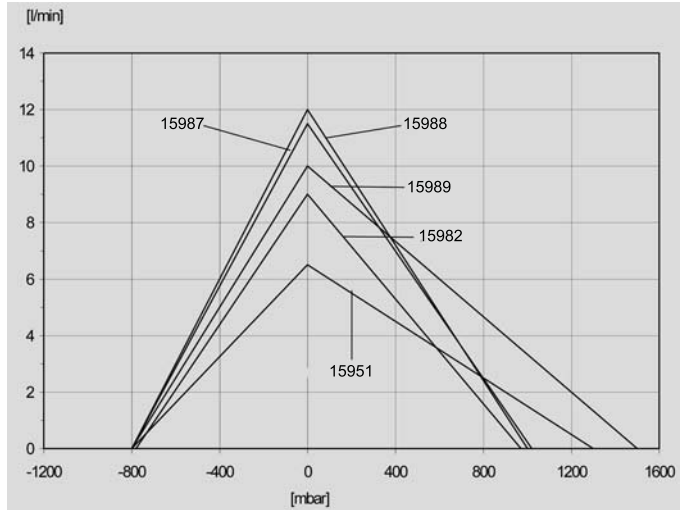

DIMENSIONS (MM)

Model	D	d	L	L ₁	L ₂
15951	50	42	106	20.5	72
15982	50	42	109	23.5	72
15987	50	42	109	23.5	72
15989	50	42	132	23.5	85
15988	50	42	132	23.5	85

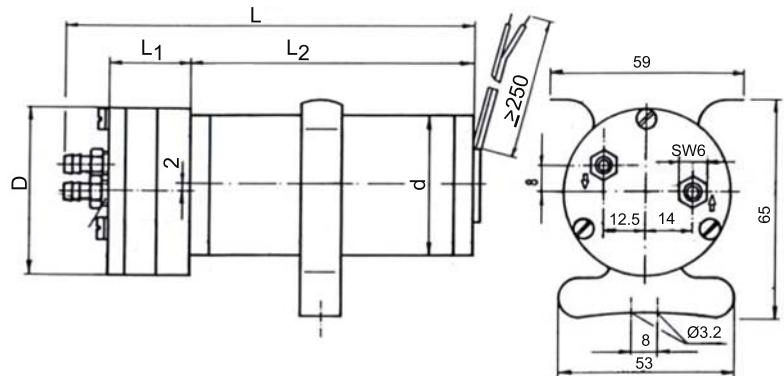

ORDERING INFORMATION

Model	Voltage	Max. Flow(L/min)	Max. Pressure (mbar)	Max Vacuum mbar	Min.Current (A) Min.Flow,No Load	Max. Current (A) Max. Flow, No Load	Max. Current (A) Max. Pressure	Weight kg
15951	12	6.5	1300	800	1.0	1.9	4.0	0.65
	9	5.0	1000	760	0.8	1.8	3.1	
	6	3.0	650	630	0.6	1.6	2.1	
15982	12	9.0	970	780	1.3	2.6	4.2	0.67
	9	7.0	710	690	1.0	2.4	3.3	
	6	5.0	560	500	0.8	1.9	2.2	
15987	12	11.5	1020	800	1.7	3.2	4.5	0.67
	9	8.5	725	700	1.4	2.8	3.5	
	6	5.5	450	510	0.9	2.2	2.3	
15989	12	10.0	1500	800	1.4	2.8	6.4	0.78
	9	8.0	1100	780	1.1	2.6	4.9	
	6	5.3	870	650	0.8	2.3	3.1	
15988	12	12.0	1000	800	1.5	3.2	5.0	0.78
	9	9.5	1000	730	1.4	2.9	4.9	
	6	6.5	650	600	0.8	2.5	3.3	