

BOXER

12KD Series Diaphragm Pump

Gas Flow Rate to 2 l/m

DESCRIPTION

The 12KD series is a double headed version of the series 12K pumps for increased flow performance. The pumps feature unique exchangeable heads and panel mounting.

Once contaminated replacement of all wetted parts takes only a few seconds with removal of two screws. The panel mounted motor remains inside of the instrument.

2 heads allows flexibility of parallel or series connection to extend the pressure / vacuum capability or to pump 2 distinct gases.

Like all other pumps in the Boxer range, this series can be customized to specific requirements. 12KD pumps are available with iron core or coreless motors.

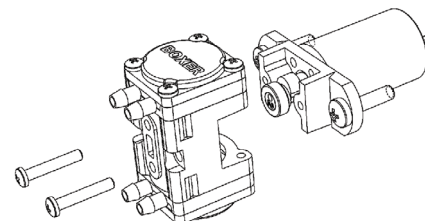

SPECIFICATIONS

GENERAL

Free Flow Parallel /Series configuration: 2/1.2 liters/min
 Max Pressure Parallel /Series config.: 600/900 mbar
 Max Vacuum Parallel /Series config.: -400/-600 mbar
 Motor:

Iron Core- 4.5 & 6.5 VDC

Coreless- 4.0, 7.0, 9.0, 13.5, & 18 VDC

Life Expectancy Iron Core Motor- 4500 hours, subject to operating environment

Life Expectancy Coreless Motor- 12000 hours, subject to operating environment

Housing Material: PPS (Polyphenylene Sulfide)

Diaphragm Material: EPDM

Valve Material: Silicone

Tubing Connection: 2.5 mm ID tubing

Weight; 35g

FLOW PERFORMANCE (AT NOMINAL PUMP VOLTAGE)

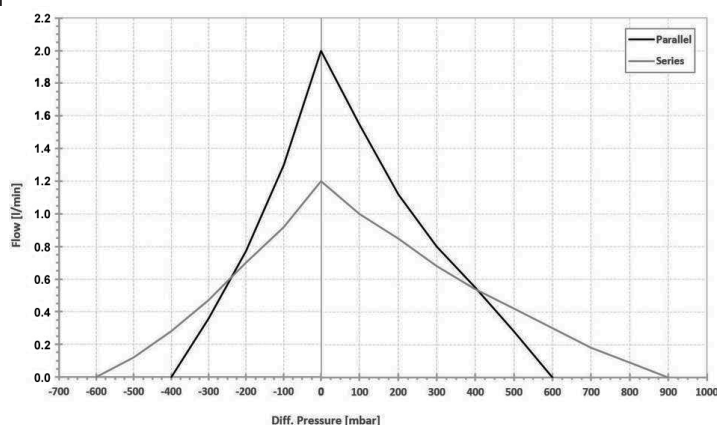

ORDERING INFORMATION

Model	Motor Type	Nominal Pump Voltage (VDC)	Nominal Motor Voltage (VDC)
1212.204	Iron Core	4.5	4.5
1212.205	Iron Core	6.5	6.5
1212.124	Coreless	4	6
1212.125	Coreless	7	9
1212.126	Coreless	9	12
1212.123	Coreless	13.5	18
1212.106	Coreless	18	24

DIMENSIONS

