

CLARK**Series PA 500-1000 Brass & SS Rotary Vane Pumps**

Flow to 316 GPH, Pressure to 230 PSI

DESCRIPTION

The PA 500-1000 series high volume rotary vane pumps are available in 6 flow ratings to meet the needs of high capacity pumping.

The rotary vane pump with brass or stainless steel housing utilizes a stainless steel AISI 304 rotor, while the pumping chamber and the vanes are in graphite carbon.

Inlet and outlet ports are 1/2" NPT female threaded.

Certain models are equipped with a built-in adjustable relief valve.

The pump can be connected to a motor with a metallic clamp or through an adapter and a flexible coupling.

SPECIFICATIONS

Pump Housing: Brass or AISI 303 Stainless Steel

Pumping Chamber: Carbon Graphite

Ports: 1/2" NPT

Max Temperature : 70° C (158° F)

Seals: NBR (Viton, EPDM upon request)

Max Motor Speed : 1725 rpm

Max System Pressure : 20 Bar (290 psi)

Mounting: Clamp or Flange

Pump Weight: clamp mount- 1.9 kg (4.2 lb)

flange mount- 2 kg (4.4 lb)

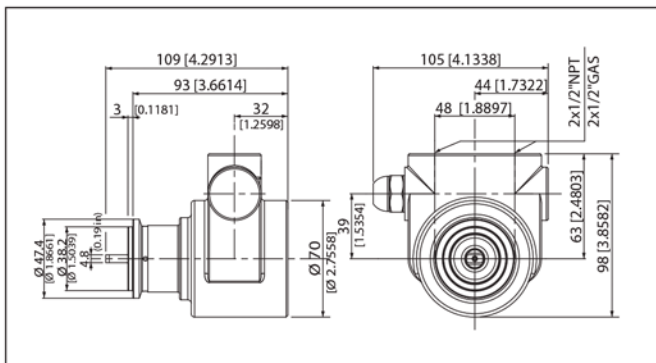
DIMENSIONS (MM)**TYPICAL APPLICATIONS**

- Post mix dispensers
- Cooling and booster systems
- Reverse osmosis
- Fuel injection systems
- Ultra filtration



NSF/ANSI 169

Stainless steel models also evaluated and determined to possess weighted average lead content of $\leq 0.25\%$ and complies with lead content requirements for "lead free" plumbing as defined by California, Vermont, Maryland, and Louisiana state laws and the U.S. Safe Drinking Water Act.

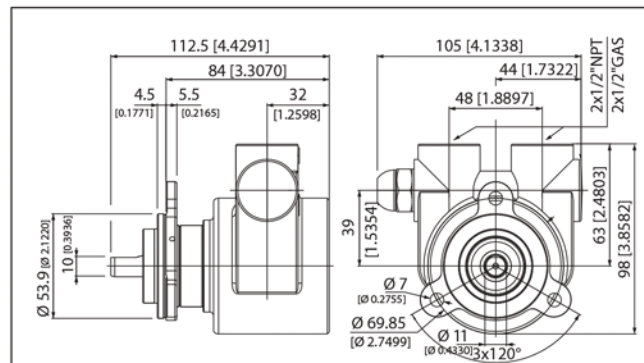

Relief valves are offered on select models of rotary vane pumps throughout the product line. Two types of relief valves are offered:

- 1) Standard Relief valve: A spring loaded bypass check valve diverts flow from the pump outlet to the pump inlet when outlet pressure exceeds setpoint (set with spring tensioning set screw).
- 2) Balanced relief valve: A pressure compensation plunger with dynamic seal and referenced (ported on one side) to atmosphere is added to the downstream side of the standard check-valve assembly. This insures that cracking pressure of the relief valve remains unchanged regardless of changes in inlet pressure (that might be a condition in a pressurized system).

The cracking pressure can be field set by adjusting the spring tension with the adjusting screw. If the cracking pressure is not customer specified it is factory preset at approximately 220 PSI for PA 500-1000 series.

It is not recommended to use the relief/bypass valve for flow control. This will result in premature wear of the valve assembly and require frequent maintenance.

PUMP MODEL SELECTION/FLOW CURVES/NEMA 56C ADAPTER

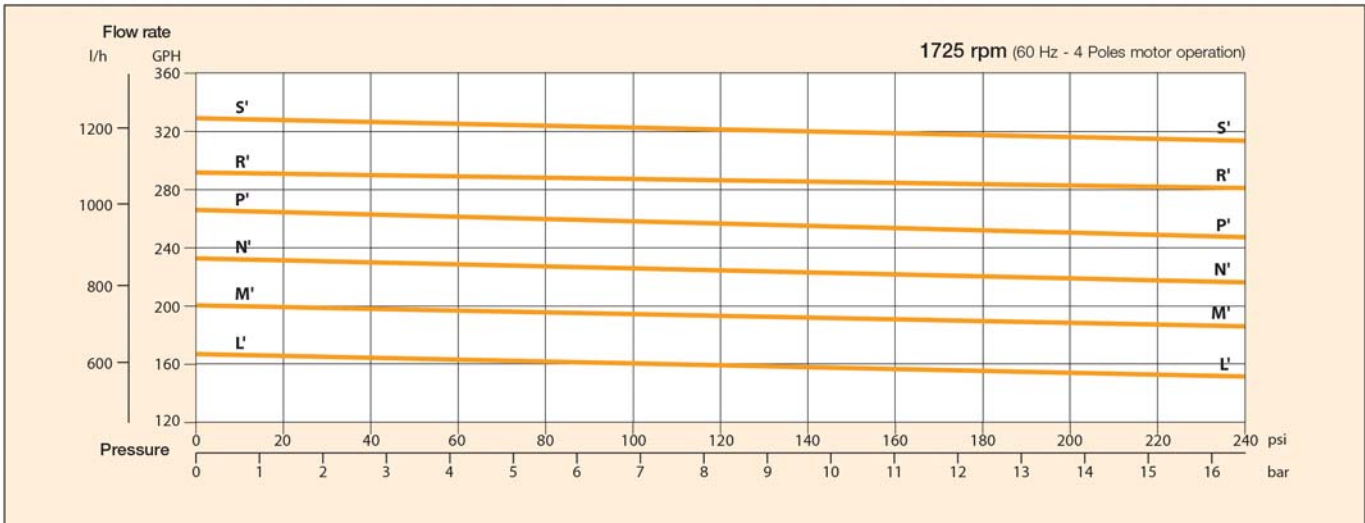
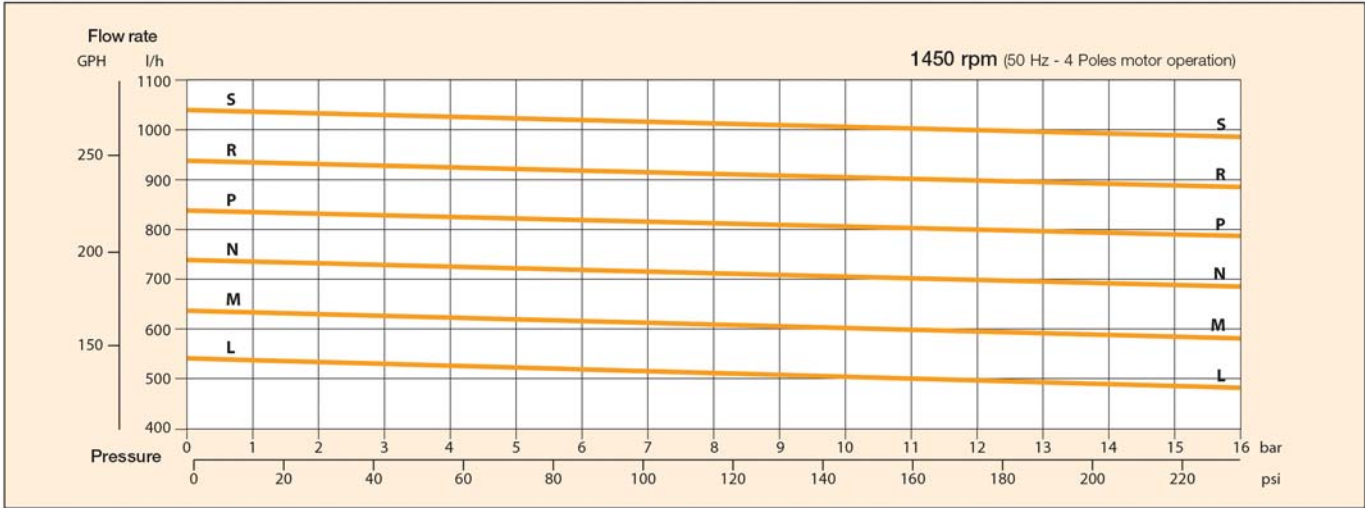

Note: Characteristics at constant motor speed, with water at 20 °C (68 F) and bypass blocked - Figures of flow are averages.
For applications involving other fluids, high temperatures or unusual processing conditions, please consult the factory or an authorized Fluid-o-Tech distributor.

Brass Model	PA500	PA501	PA500F	PA501F	PA600	PA601	PA600F	PA601F	PA700	PA701	PA700F	PA701F	PA800	PA801	PA800F	PA801F	PA900	PA901	PA900F	PA901F	PA1000	PA1001	PA1000F	PA1001F
Flow Figure	L-L				M-M				N-N				P-P				R-R				S-S			
Mounting	Clamp	Clamp	Flange	Flange	Clamp	Clamp	Flange	Flange	Clamp	Clamp	Flange	Flange	Clamp	Clamp	Flange	Flange	Clamp	Clamp	Flange	Flange	Clamp	Clamp	Flange	Flange
Relief Valve	NO	STD	NO	STD	NO	STD	NO	STD	NO	STD	NO	STD	NO	STD	NO	STD	NO	STD	NO	STD	NO	STD	NO	STD
SS Model	PA510	PA511	PA510F	PA511F	PA610	PA611	PA610F	PA611F	PA710	PA711	PA710F	PA711F	PA810	PA811	PA810F	PA811F	PA910	PA911	PA910F	PA911F	PA1010	PA1011	PA1010F	PA1011F
Flow Figure	L-L				M-M				N-N				P-P				R-R				S-S			
Mounting	Clamp	Clamp	Flange	Flange	Clamp	Clamp	Flange	Flange	Clamp	Clamp	Flange	Flange	Clamp	Clamp	Flange	Flange	Clamp	Clamp	Flange	Flange	Clamp	Clamp	Flange	Flange
Relief Valve	NO	STD	NO	STD	NO	STD	NO	STD	NO	STD	NO	STD	NO	STD	NO	STD	NO	STD	NO	STD	NO	STD	NO	STD

Model 92-80-03 NEMA 56C Adapter	
#	Description
1	NEMA 56C Adapter
2	10 mm Washer
3	Screw 1 3/8-16x38 UNC

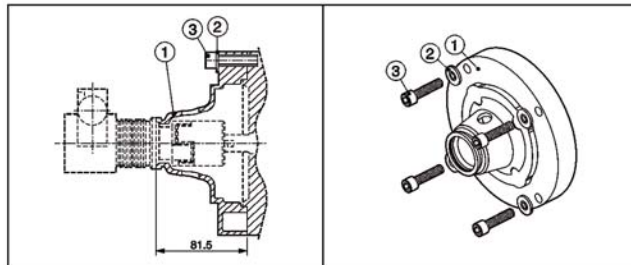

Model 91-81-11 NEMA 56C Coupling	
#	Description
1	Coupling w/5/8" Bore
2	M6 x 8 Set Screw
3	Spider
4	Coupling, Flat Side

